

## Preferred Caterers

### Collective

FOOD & HOSPITALITY EXPERIENCES

(04) 472 0167 [www.collective.co.nz](http://www.collective.co.nz)

### nOSH

CATERING + EVENTS

(04) 479 0529 [www.nosh.co.nz](http://www.nosh.co.nz)



SIMPLY FOOD

(04) 472 7333 [www.simplyfood.co.nz](http://www.simplyfood.co.nz)

RUTH PRETTY  
CATERING

(06) 364 3161 [www.ruthpretty.co.nz](http://www.ruthpretty.co.nz)



(04) 232 6511 [www.sarahsearankecatering.co.nz](http://www.sarahsearankecatering.co.nz)

For all enquiries, please contact:

For further details, or to book your event, contact:

The Administrator  
New Zealand Portrait Gallery  
Te Pūkenga Whakaata  
PO Box 25540  
Wellington 6140

+64 4 472 2298  
[admin@nzportraitgallery.org.nz](mailto:admin@nzportraitgallery.org.nz)  
[www.nzportraitgallery.org.nz](http://www.nzportraitgallery.org.nz)

December 2019

## The Location

The New Zealand Portrait Gallery Te Pūkenga Whakaata is located in Shed 11, 60 Lady Elizabeth Lane, Wellington Waterfront.

Conveniently situated in the heart of the Wellington CBD, it is within walking distance of the Railway Station and several bus stops. There are a number of public car parks just a short walk away. The Gallery is a fully accessible venue.

Cover image: R J Kelly *Marriage Portrait* 1905, gift of the artist's estate

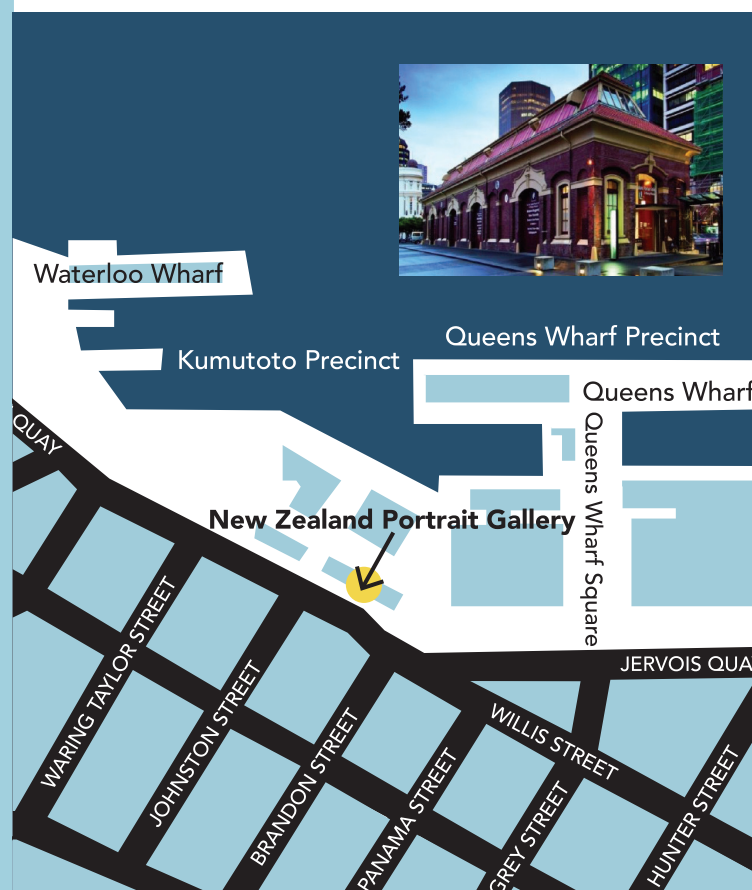

## Venue Hire

### New Zealand Portrait Gallery Te Pūkenga Whakaata



New Zealand  
Portrait Gallery  
Te Pūkenga Whakaata

# Rent a heritage venue in the heart of Wellington for your function

## Our Advantages

- An elegant heritage setting in the heart of the city.
- Rebuilt and earthquake-strengthened building to 85% NBS.
- Large uncluttered space suitable for corporate hospitality, product launches, fashion shows, receptions, private banquets, lectures.
- Flexible space that can be divided into smaller areas.
- Capacity for 300 depending on format.
- Option to self-cater or hire catering service.
- BOSE sound system, data projection equipment and folding chairs available.
- Easy level access from street and waterfront.
- Kitchenette with running water.

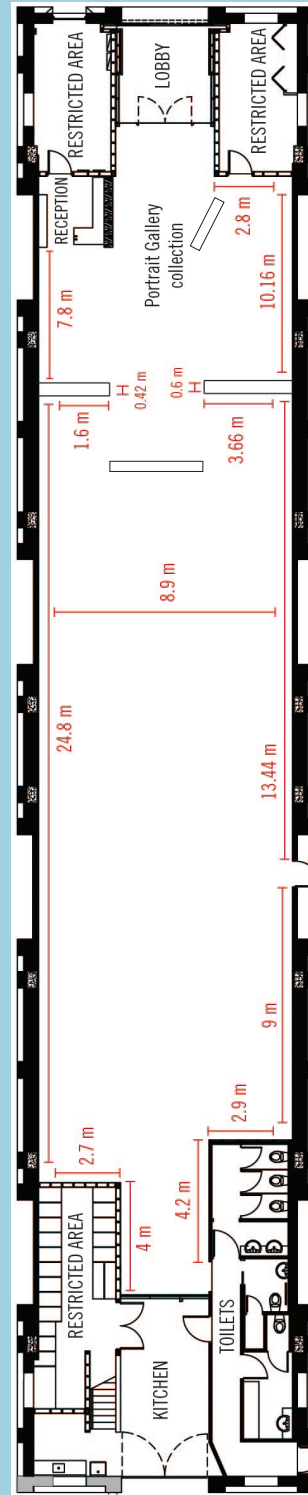

## Our Rates

Morning Events 7 - 10 am \$600 + GST

Evening Events 4.30 - 10.30 pm \$1000 + GST

Extended hours \$200 p/hr + GST

Photo Shoots \$200 p/hr + GST

Exhibitions by proposal, rates by negotiation.

## Optional Services

BOSE sound system, data projector, screen, pointer, lapel microphone \$50 + GST

Additional security for events of over 150 people \$50 p/hr + GST

Cleaning \$50 p/hr + GST

With particular exhibitions, our public opening times and heritage restrictions, there are sometimes limitations on food, drink, and decorations.

